

CMATVS3V3
CMATVS5V0

**SURFACE MOUNT SILICON
TRANSIENT VOLTAGE SUPPRESSORS**



SOD-923 CASE



www.centrasemi.com

DESCRIPTION:

The CENTRAL SEMICONDUCTOR CMATVS3V3 Series types are Low Leakage, Fast Response TVSs packaged in a space saving SOD-923 surface mount package. These devices are designed to protect sensitive equipment against ESD damage.

**MARKING CODES: CMATVS3V3: E
CMATVS5V0: F**

APPLICATIONS:

- PDAs
- Memory Card Ports
- Mobile Phones
- Instrumentation

FEATURES:

- Small, 1.0 x 0.6 x 0.4mm, SOD-923 Surface Mount Package
- Low Leakage Current

MAXIMUM RATINGS: ($T_A=25^\circ\text{C}$)

Peak Power Dissipation (8x20 μs)
ESD Voltage (IEC 61000-4-2, Air)
ESD Voltage (IEC 61000-4-2, Contact)
Operating and Storage Junction Temperature

SYMBOL

P_{PK}
 V_{ESD}
 V_{ESD}
 T_J, T_{stg}

UNITS

W
kV
kV
 $^\circ\text{C}$

ELECTRICAL CHARACTERISTICS: ($T_A=25^\circ\text{C}$) $V_F=0.9\text{V MAX @ } I_F=10\text{mA}$ (for all types)

Type	Maximum Reverse Stand-off Voltage	Minimum Breakdown Voltage	Test Current	Maximum Reverse Leakage Current	Maximum Clamping Voltage	Peak Pulse Current	Typical Capacitance @ 0V Bias
	V_{RWM}	$V_{BR @ I_T}$	I_T	$I_R @ V_{RWM}$	$V_C @ I_{PP}$	I_{PP}	C
	V	V	mA	μA	V	A	pF
CMATVS3V3	3.3	5.0	1.0	2.5	11	7.0	45
CMATVS5V0	5.0	6.2	1.0	1.0	12.3	7.0	40

CMATVS3V3
CMATVS5V0

SURFACE MOUNT SILICON
TRANSIENT VOLTAGE SUPPRESSORS



SOD-923 CASE - MECHANICAL OUTLINE

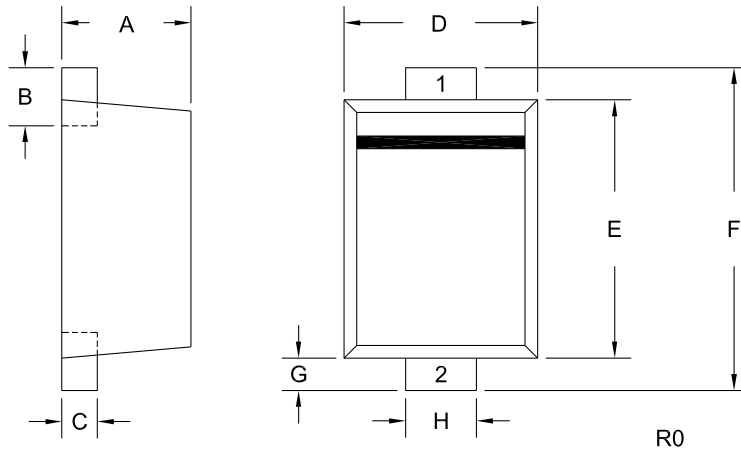

LEAD CODE:

- 1) Cathode
- 2) Anode

MARKING CODES:

CMATVS3V3: E
CMATVS5V0: F

DIMENSIONS				
SYMBOL	INCHES		MILLIMETERS	
	MIN	MAX	MIN	MAX
A	0.015	0.016	0.39	0.41
B	0.004	0.010	0.10	0.26
C	0.003	0.006	0.08	0.14
D	0.022	0.026	0.55	0.65
E	0.030	0.033	0.75	0.85
F	0.035	0.043	0.90	1.10
G	0.002	0.006	0.05	0.15
H	0.007	0.011	0.17	0.27

SOD-923 (REV: R0)

R5 (2-April 2015)

**CMATVS3V3
CMATVS5V0**

**SURFACE MOUNT SILICON
TRANSIENT VOLTAGE SUPPRESSORS**



TYPICAL ELECTRICAL CHARACTERISTICS

Leakage Current

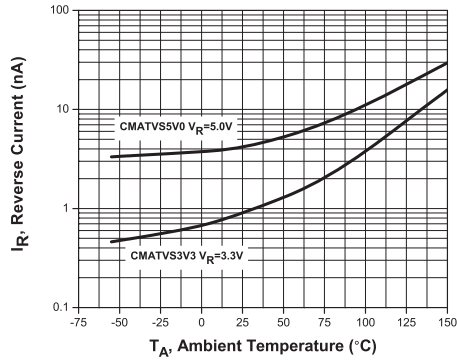

Capacitance

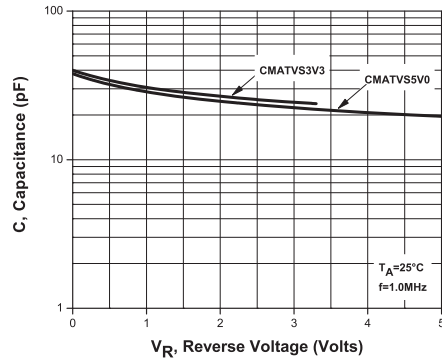

Non-Repetitive Pulse Waveform

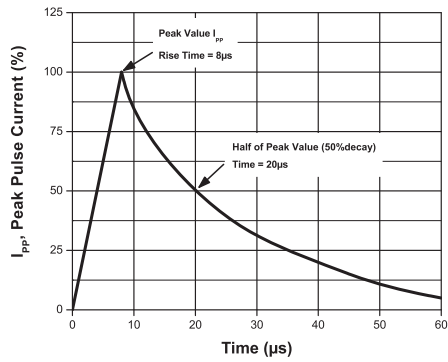

Forward Voltage

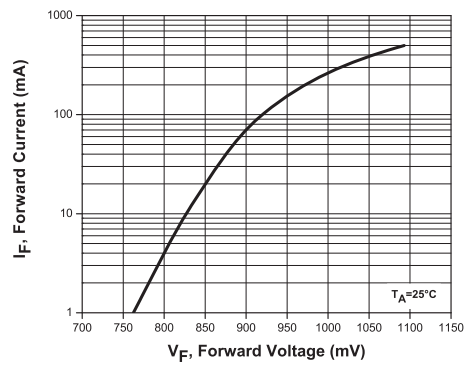

Normalized Power & Current Derating

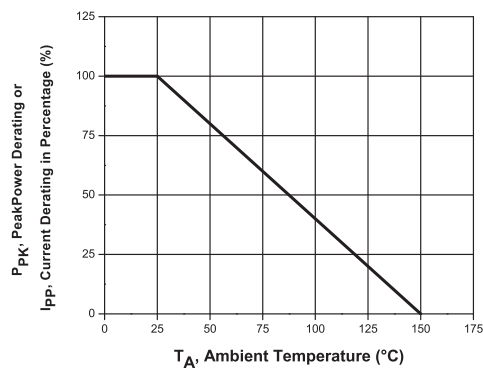

R5 (2-April 2015)

CMATVS3V3
CMATVS5V0

**SURFACE MOUNT SILICON
TRANSIENT VOLTAGE SUPPRESSORS**



SERVICES

- Bonded Inventory
- Custom Electrical Screening
- Custom Electrical Characteristic Curves
- SPICE Models
- Custom Packaging
- Package Base Options
- Custom Device Development/ Multi Discrete Modules (MDM™)
- Bare Die Available for Hybrid Applications

LIMITATIONS AND DAMAGES DISCLAIMER: In no event shall Central be liable for any collateral, indirect, punitive, incidental, consequential, or exemplary damages in connection with or arising out of a purchase order or contract or the use of products provided hereunder, regardless of whether Central has been advised of the possibility of such damages. Excluded damages shall include, but not be restricted to: cost of removal or reinstallation, rework, ancillary costs to the procurement of substitute products, loss of profits, loss of savings, loss of use, loss of data, or business interruption. No claim, suit, or action shall be brought against Central more than two (2) years after the related cause of action has occurred.

In no event shall Central's aggregate liability from any warranty, indemnity, or other obligation arising out of or in connection with a purchase order or contract, or any use of any Central product provided hereunder, exceed the total amount paid to Central for the specific products sold under a purchase order or contract with respect to which losses or damages are claimed. The existence of more than one (1) claim against the specific products sold to Buyer under a purchase order or contract shall not enlarge or extend this limit.

Buyer understands and agrees that the foregoing liability limitations are essential elements of a purchase order or contract and that in the absence of such limitations, the material and economic terms of the purchase order or contract would be substantially different.

R5 (2-April 2015)